

Distributed by

MATHYS 
European Orthopaedics



Offset Reamer Drivers – Technical Guide

enztec

Contents

Offset Reamer Drivers – Technical Guide

| | |
|-------------------------------------|----|
| Overview..... | 1 |
| Components & Features..... | 2 |
| Assembly Instructions..... | 3 |
| Attach/Detach Reamer – Locking..... | 7 |
| Attach/Detach Reamer – Open..... | 8 |
| Disassembly Instructions..... | 9 |
| Catalogue..... | 13 |
| Nota Bene..... | 14 |

Distributed by

MATHYS 
European Orthopaedics

 **enztec**

Overview

The Enztec Reamer Drivers allow the reamer to be placed in the incision prior to connection, supporting a Direct Anterior Approach.

These are available, with a traditional locking capture, or novel open capture.

The locking version allows forward and reverse reaming with crossbar reamers.

The open version is for forward reaming only.



Distributed by

MATHYS 
European Orthopaedics

enztec

Components & Features

The Enztec Offset Reamer Drivers consist of five components; the Offset Body, Offset Cover, Offset Coupling, Offset Drive Train and Handle.

The Offset Coupling is available with a Zimmer, Hudson, or Large AO connection. The Offset Drive Train is available with a traditional locking capture, or novel open capture.

This modularity provides set flexibility as all parts are field changeable.

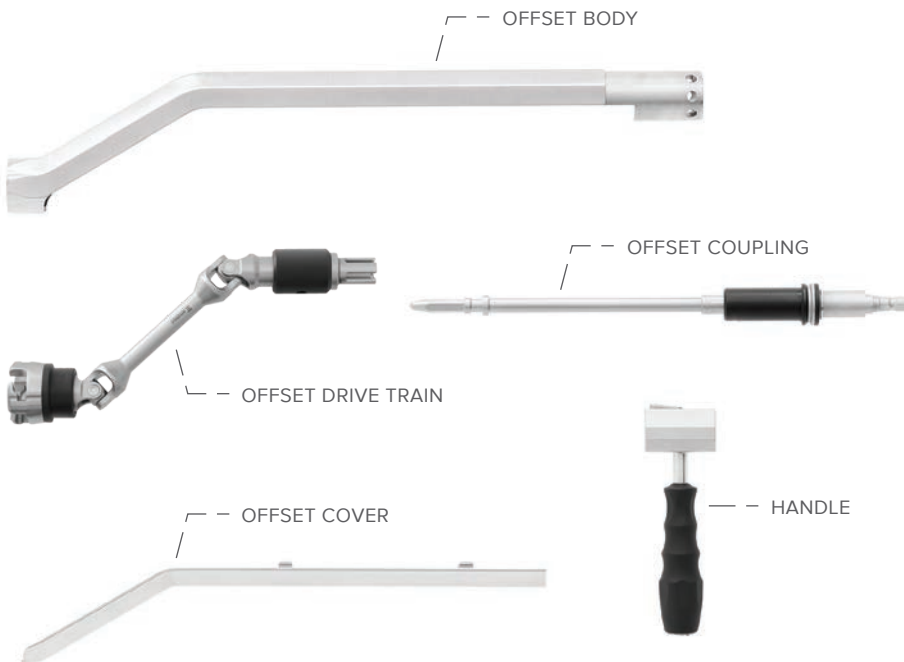

Distributed by

MATHYS 
European Orthopaedics

enztec

Step One – Assembly

Fit Offset Drive Train

Slide the Offset Drive Train through the distal end of the Offset Body, ensuring the distal portion is seated in the body.

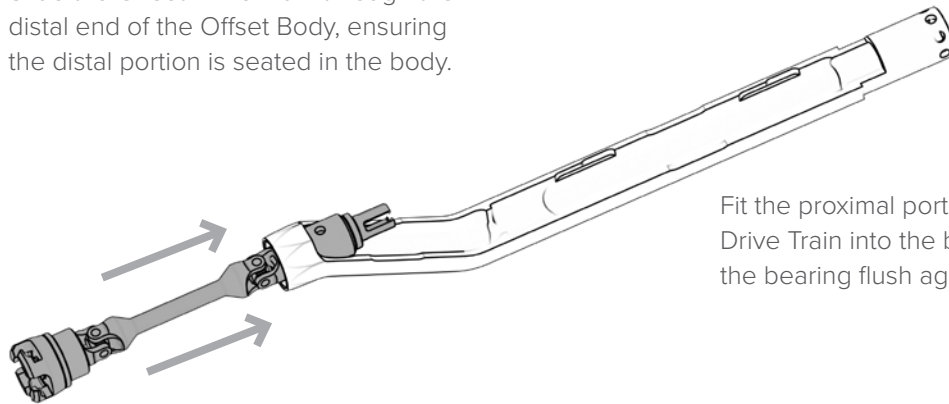

Fit the proximal portion of the Offset Drive Train into the body, pushing the bearing flush against the shoulder.

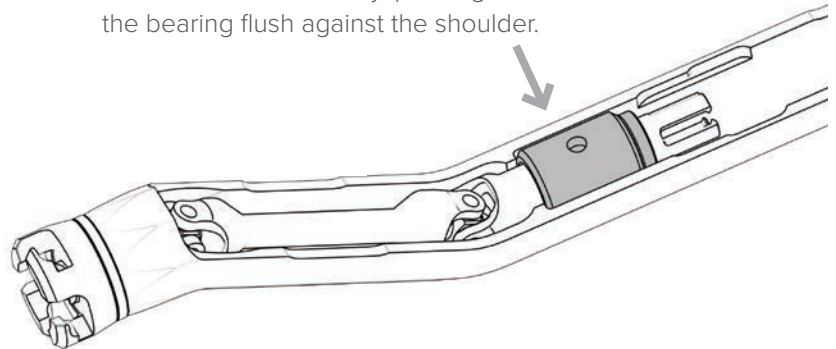

Distributed by

Step Two – Assembly

Fit Offset Drive Shaft

Slide the Offset Drive Shaft through the proximal end of the Offset Body.

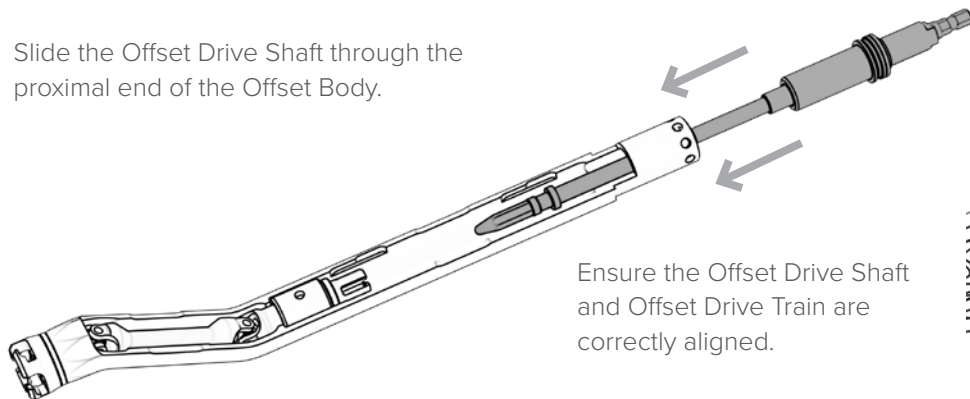

Ensure the Offset Drive Shaft and Offset Drive Train are correctly aligned.

Push until you hear an audible click as the Offset Drive Shaft engages into the Offset Drive Train.

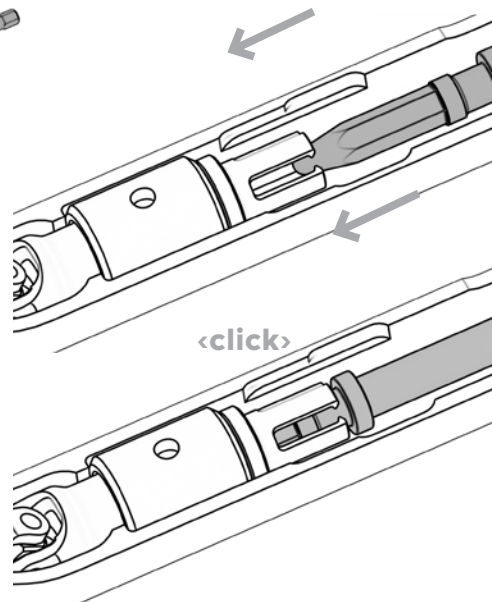

Distributed by

MATHYS 
European Orthopaedics

 **enztec**

Step Three – Assembly

Fit Offset Cover

Position Offset Cover onto Offset Body, aligning markings and slide towards the distal end of the instrument to connect.

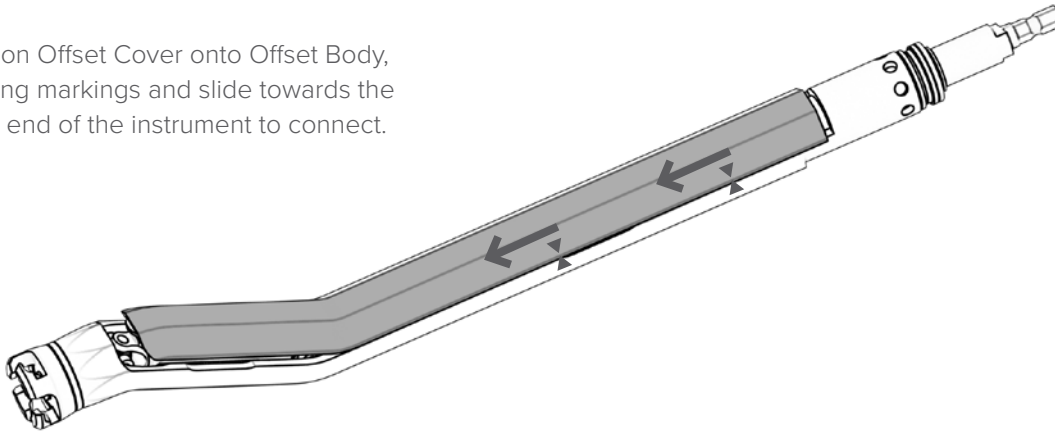

Distributed by

Step Four – Assembly

Fit Handle

Slide Handle onto Offset Body.

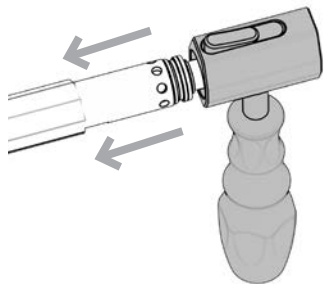

Ensure the handle securely locks into position by pushing it towards the Offset Body until you hear an audible click.

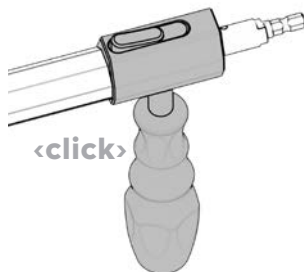

The Handle can be indexed in 45° increments by depressing the button on top of the handle and rotating to the desired position.

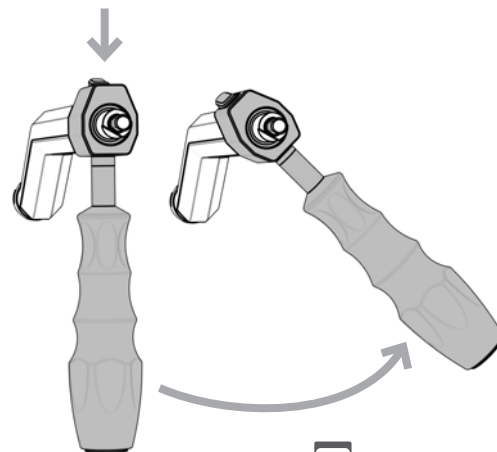

Distributed by

MATHYS 
European Orthopaedics

 **enztec**

Attach / Detach Reamer – Locking

Offset Reamer Drivers – Technical Guide | 7

The Enztec Offset Reamer Driver – Locking is compatible with crossbar reamers

Push reamer against the coupling head sleeve.

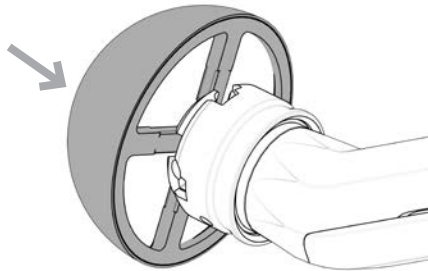

Twist the reamer in a clockwise direction to lock into the coupling.

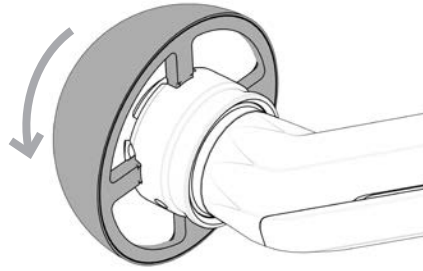

To detach, pull sleeve away from reamer and twist reamer anticlockwise to remove.

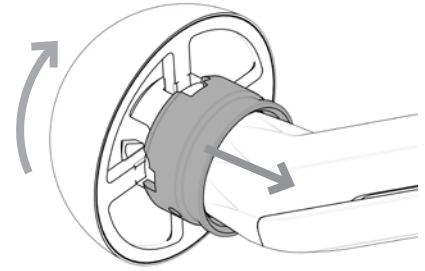

Note that if the drill is not attached you may need to hold the protruding end of the Offset Drive Shaft to prevent rotation of the coupling head.

Attach / Detach Reamer – Open

The Enztec Offset Reamer Driver – Open is compatible with crossbar reamers

Push reamer into coupling head.

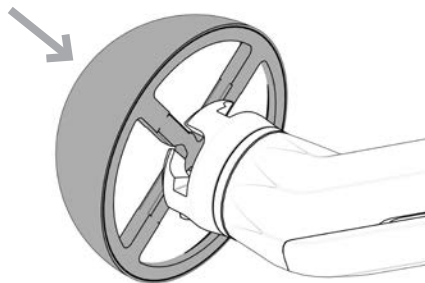

Twist in a clockwise direction to attach.

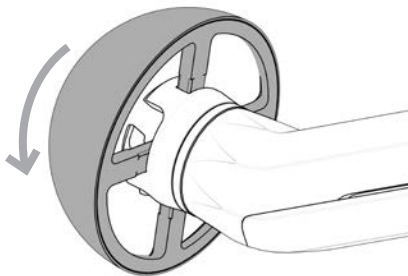

To detach, twist reamer anticlockwise and remove reamer.



Note that if the drill is not attached you may need to hold the protruding end of the Offset Drive Shaft to prevent rotation of the coupling head.

Step One – Disassembly

Remove Handle

Depress the button on the top of the handle and slide the handle off the Reamer Driver.

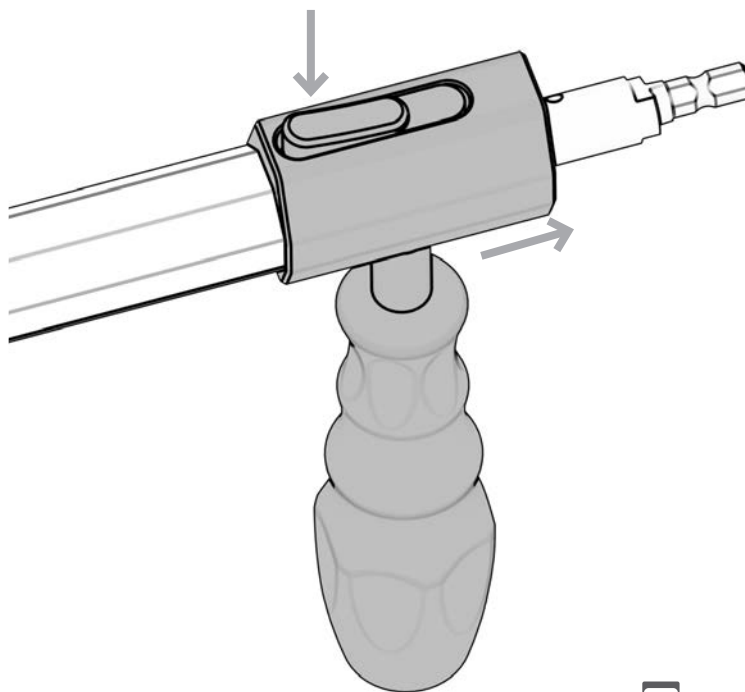

Distributed by

MATHYS 
European Orthopaedics

enztec

Step Two – Disassembly

Remove Offset Drive Shaft

Pull the protruding end of the Offset Drive Shaft away from the body to remove.

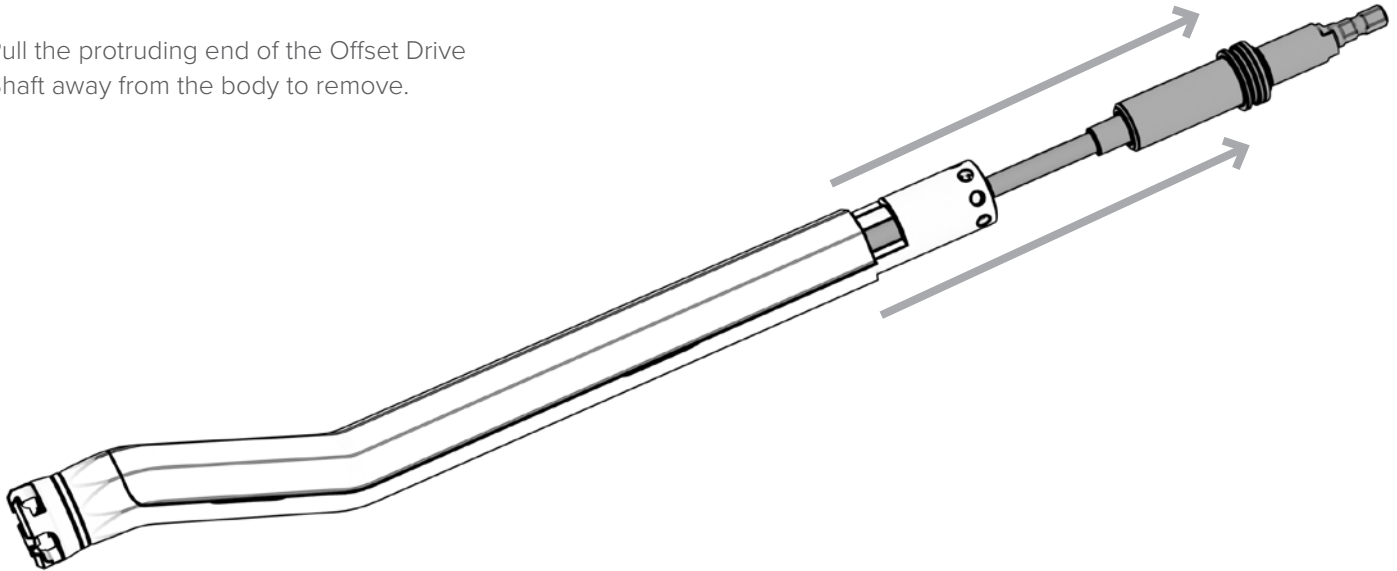

Distributed by

Step Three – Disassembly

Remove Offset Cover

Slide the Offset Cover towards the proximal end of the instrument.

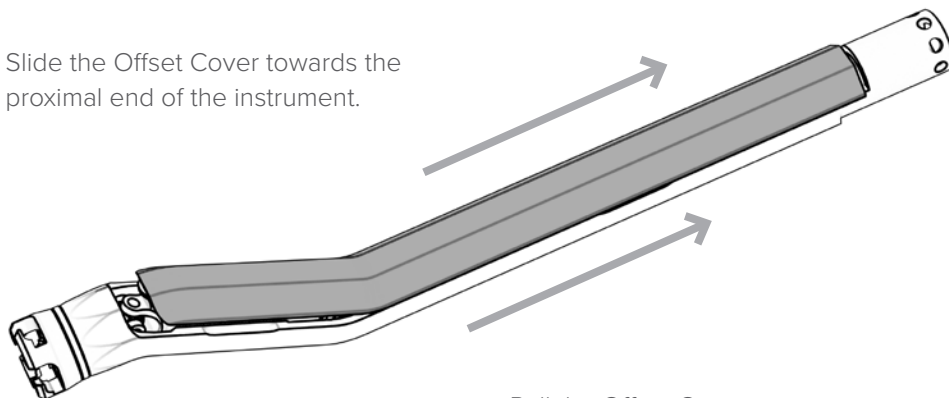

Pull the Offset Cover away from the Offset Body.

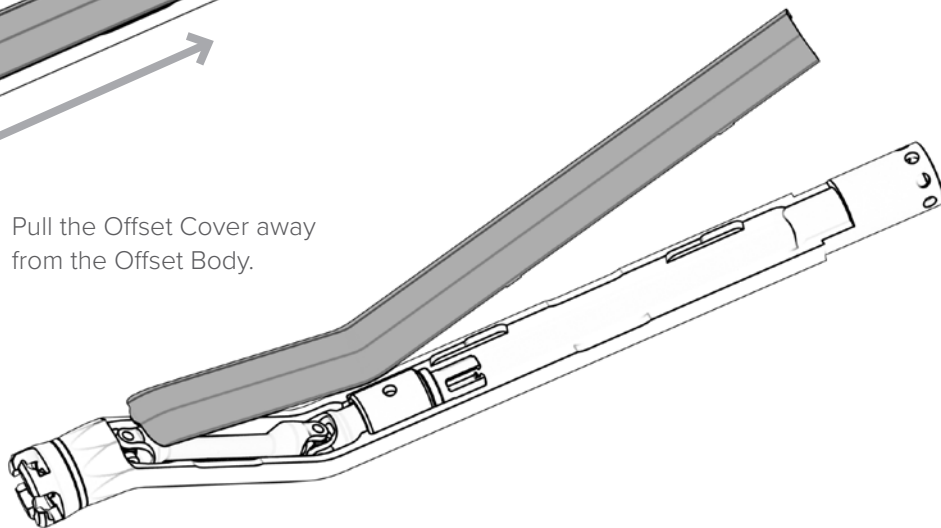

Step Four – Disassembly

Remove Offset Drive Train

Pull the Offset Drive Train bearing away from the Offset Body.

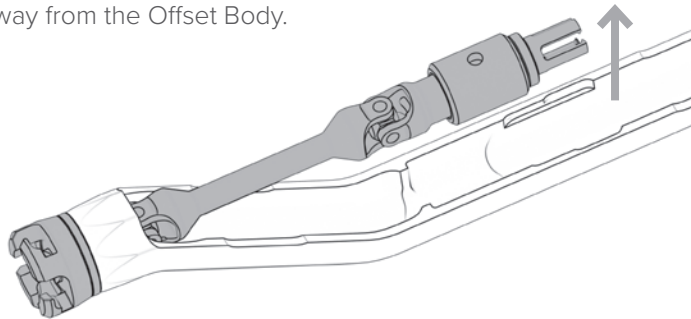

Pull the Offset Drive Train out of the distal end of the Offset Body.

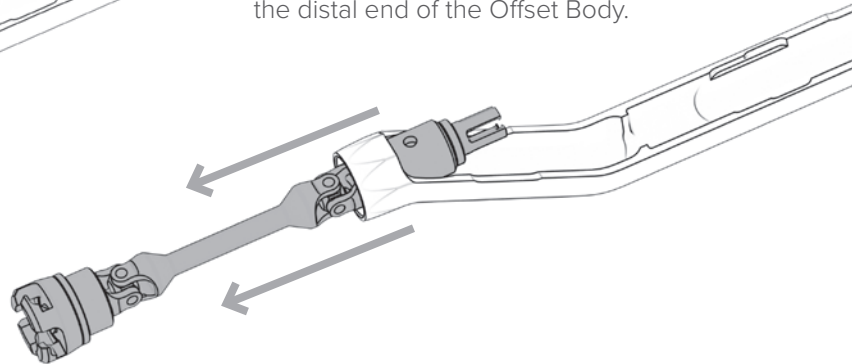

Distributed by

MATHYS 
European Orthopaedics

enztec

Cleaning

Pre Cleaning

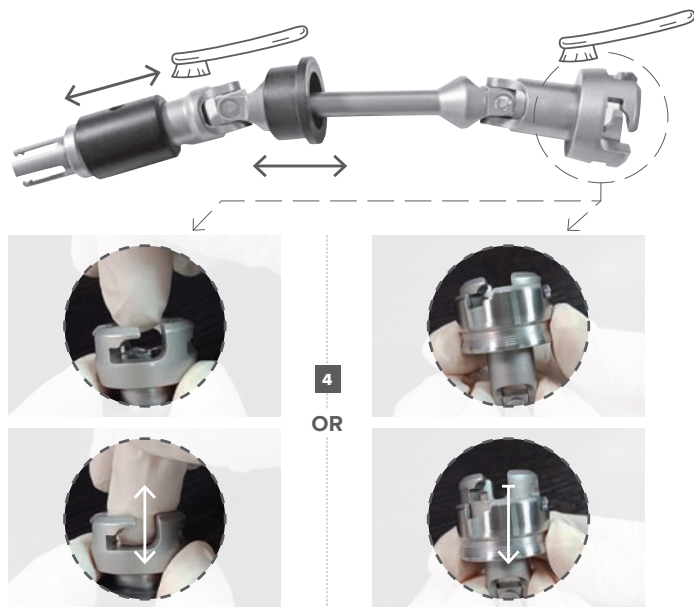

Distributed by

MATHYS 
European Orthopaedics

Post Cleaning Lubrication

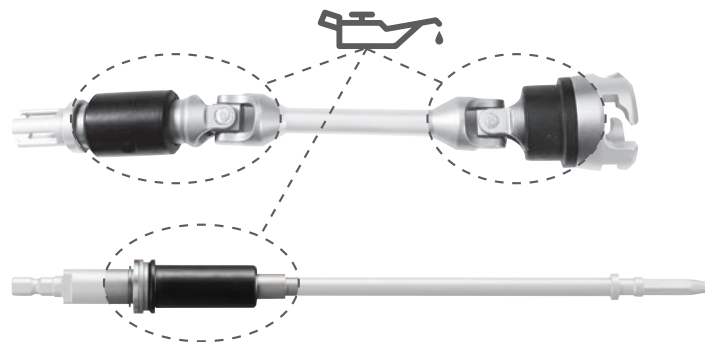

- During manual cleaning, actuate all moving parts to ensure access to all areas.
- Post cleaning, apply lubricant to all joint areas as highlighted, to extend longevity of your device.

enztec

Offset Reamer Drivers

| | |
|-------------|---|
| 51.34.1150A | Offset reamer driver – Locking – AO |
| 51.34.1151A | Offset reamer driver – Open – AO |
| 51.34.1169A | Offset reamer driver – Locking – Zimmer |
| 51.34.1170A | Offset reamer driver – Open – Zimmer |
| 51.34.1171A | Offset reamer driver – Locking – Hudson |
| 51.34.1172A | Offset reamer driver – Open – Hudson |



Replacement Parts

4250-7048 Offset Body

4250-7031 Offset Cover

4250-7012 Handle

OFFSET DRIVE TRAIN

4250-7035 Open

4250-7036 Locking – Crossbar

OFFSET COUPLING

4250-7032 Zimmer

4250-7033 Hudson

4250-7034 Large AO

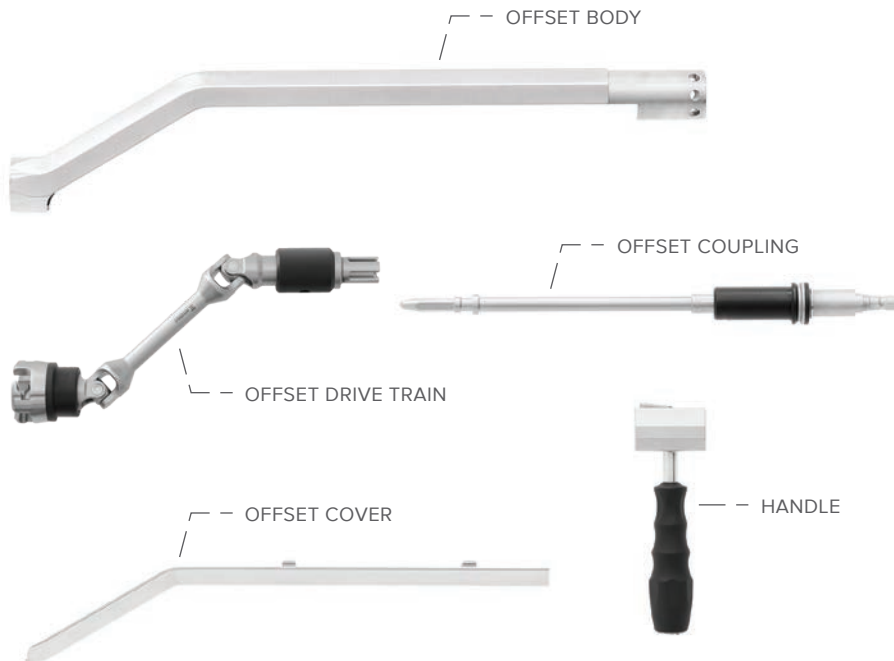

Distributed by

MATHYS 
European Orthopaedics

enztec

Nota Bene

A surgeon must always rely on his or her own professional clinical judgement when deciding which products and/or techniques to use on individual patients. Enztec is not dispensing medical advice and recommends that surgeons be trained in orthopaedic surgeries before performing any surgeries.

The information presented is intended to demonstrate the breadth of Enztec product offerings. Always refer to the package insert, product label and/or user instructions before using any Enztec product. Products may not be available in all markets. Product availability is subject to the regulatory or medical practices that govern individual markets. Please contact your Enztec representative if you have any questions about the availability of Enztec products in your area.

Enztec own, use or have applied for the following trademarks or service marks: Enztec.



Enztec Limited
3/17 Print Place
Middleton
Christchurch 8024
New Zealand

Contact:

Enztec Limited
P.O. Box 31029, Ilam
Christchurch, 8444
New Zealand
Ph: + 64 3 348 0203
W: www.enztec.com

Distributed by:

Mathys Ltd Bettlach
Robert Mathys Strasse 5
P.O. Box
2544 Bettlach
Switzerland
www.mathysmedical.com

© 2020 Enztec Limited
All rights reserved.

Distributed by

MATHYS 
European Orthopaedics

 **enztec**